

Meeting of the Douglas Open Space Committee January 31, 2024, 2 PM at the Douglas Municipal Center.

Members Present: Sue Perkins, Kathy Richards, Lisa Mosczynski, Becky Kalagher.

S. Perkins opened the workshop at 2:06 and stated that the meeting was being videoed.

Purpose of the workshop. Prioritizing open space opportunities in the Southeast quadrant of town.

#1 Bounded by South St. to Pine St, to Southeast Main St.

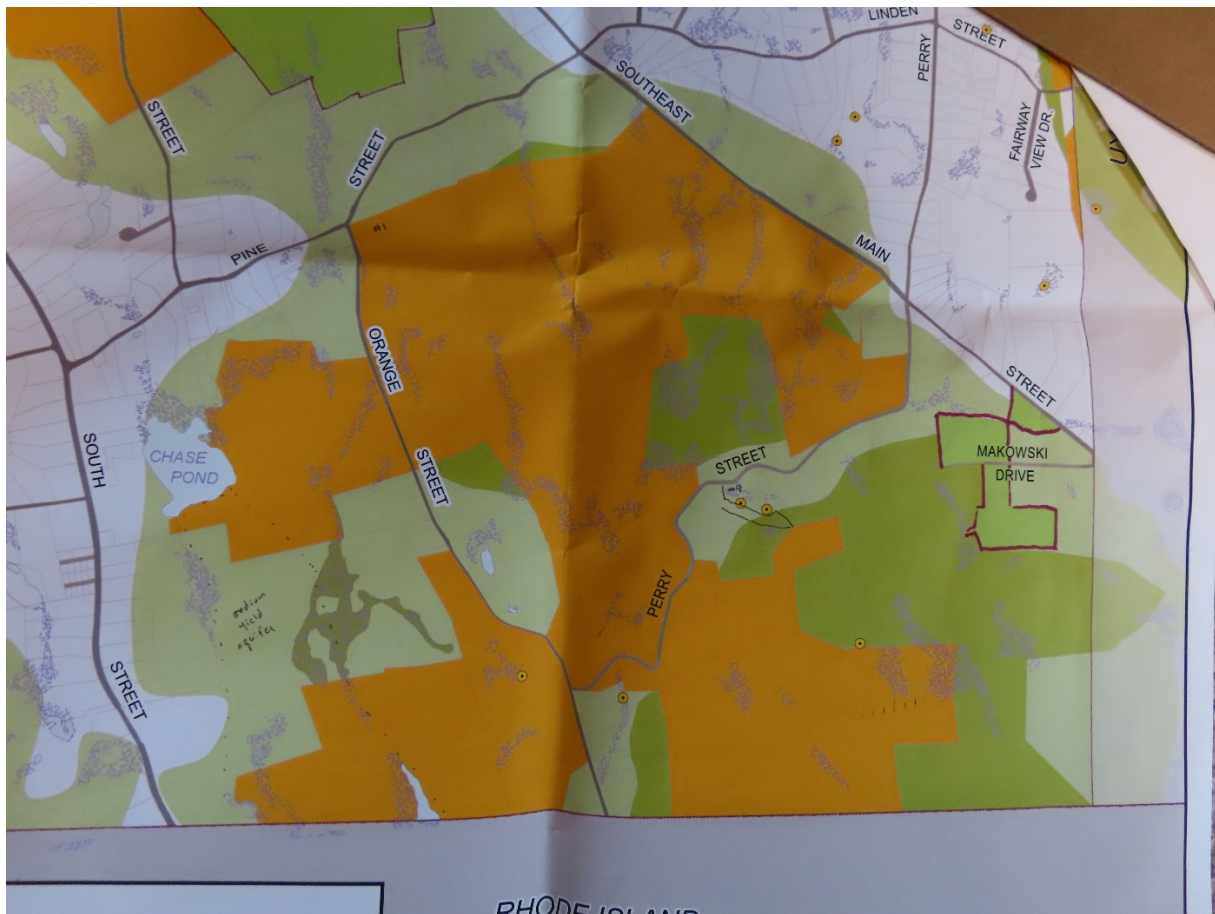

1. Former owner's wishes to preserve Tom & Pam Schwartz
2. Contains core habitat, critical natural landscapes, and potential vernal pool.
3. Greene Brook listed in the Douglas Master Plan: The most significant watershed areas are located in the western half of town and the lower southeast section of town near Greene Brook. It is important to monitor these areas as Douglas depends on groundwater for the town's water supply.
4. Medium yield aquifer – South of Chase Pond
5. Wildlife corridors connects to Round Top
6. Recreational opportunities

#2 Bounded by Downs Road, Southeast Main Street, Pine Street, and South Street.



1. Existing conservation property – Keevan
2. Contains critical natural landscape, potential vernal pool.
3. Chapter 61 property about Keevan on Vine St. and across Vine St.
4. Wildlife corridor.
5. Expand trail system from Keevan Conservation Area.

#3 Bounded by Wallum Lake Road, Walnut Street, Chestnut Street to South Street.

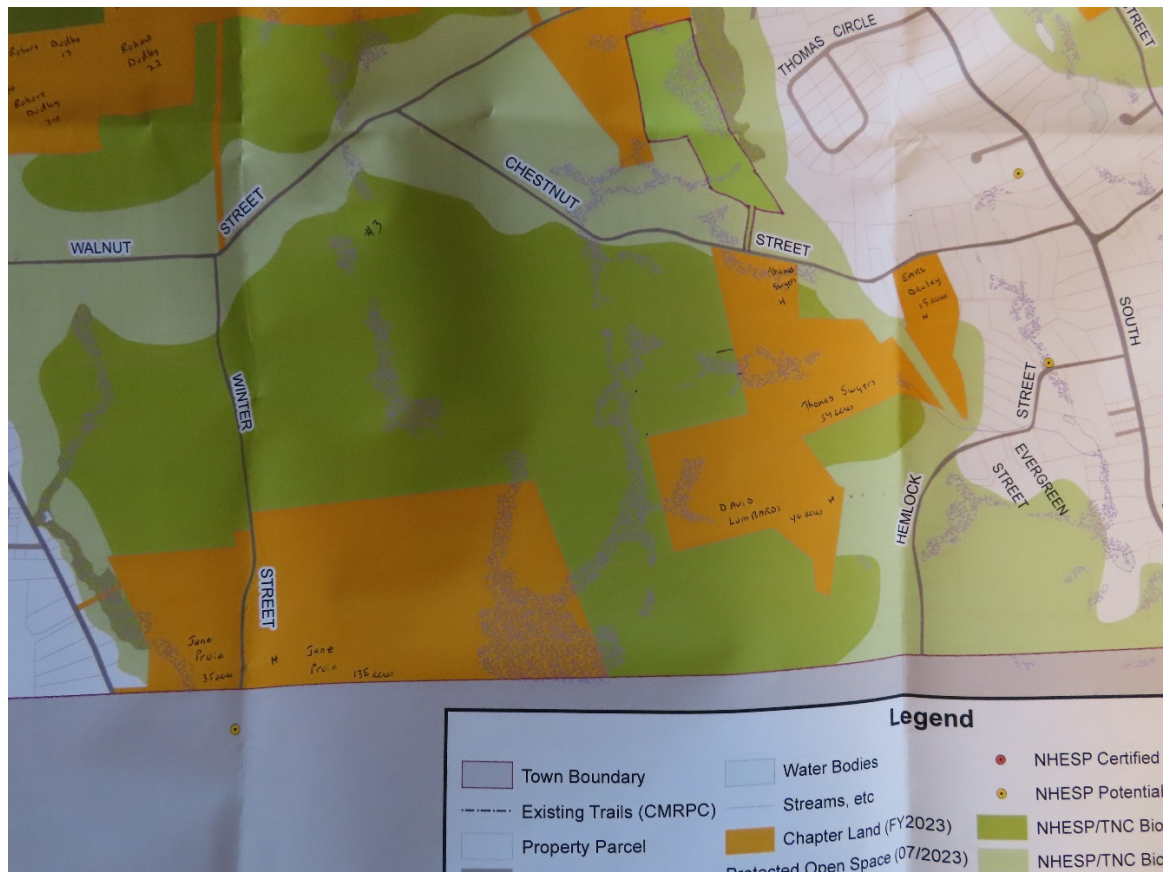

1. Contains core habitat and critical natural landscape.
2. Recreational opportunities.
3. Possible connection to Tinkerville conservation land across Chestnut Street – connection to block #4.

#4 Bounded by Wallum Lake Road, SNETT, South Street, Chestnut Street to Walnut Street.

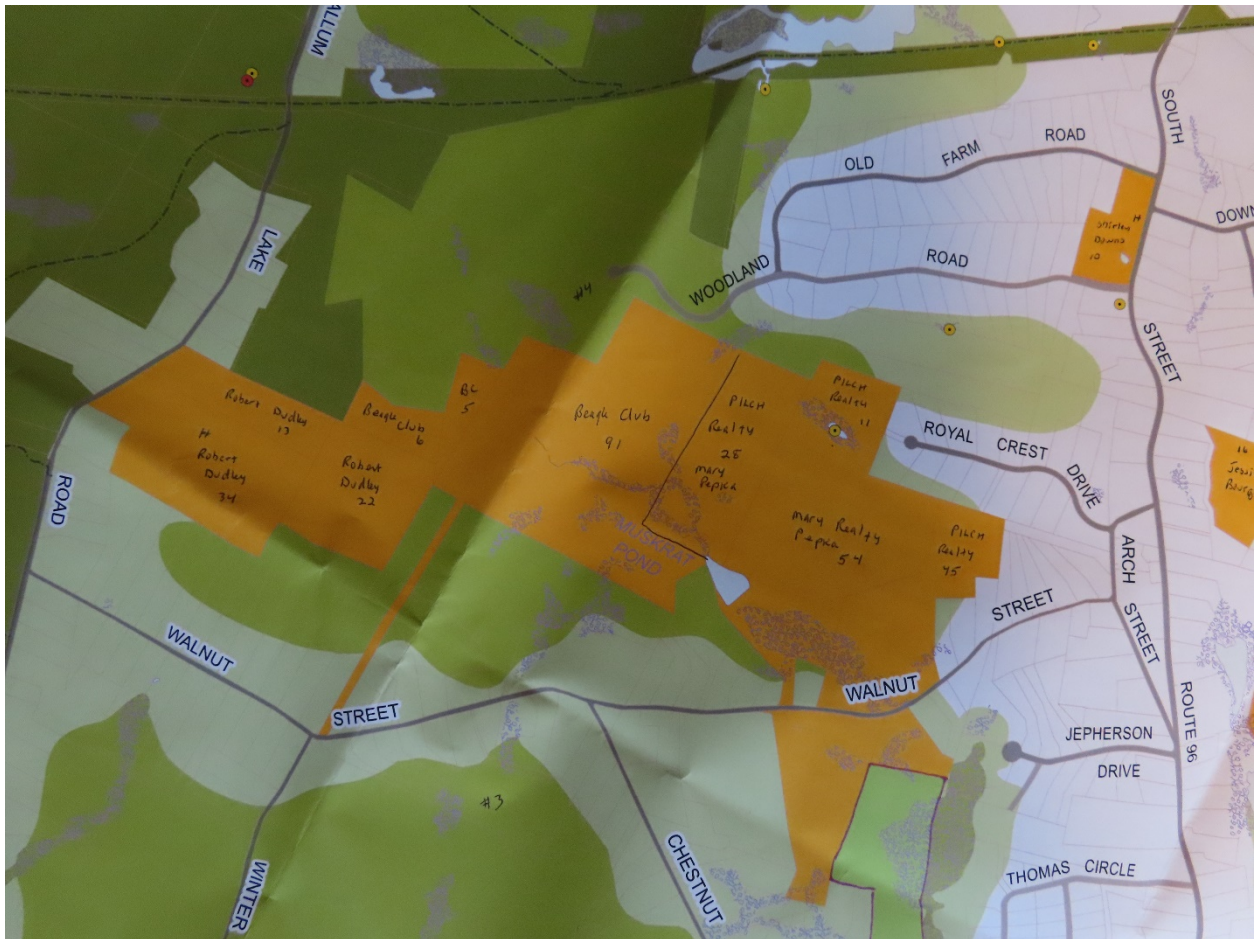

1. Contains town property Tinkerville conservation land.
2. Chapter 61 property abutting Tinkerville conservation land.
3. Contains core habitat and critical natural landscape. Potential vernal pool.
4. Wildlife corridor.
5. Possible recreational opportunities and connection to Douglas State Forest.
6. Recent flooding at Walnut Street where Tinkerville Brook crosses.
7. Agricultural land.

#5 Bounded by SNETT, Wallum Lake Road, Southwest Main Street, to South Street.



1. Contains core habitat and critical natural landscape.
2. Wildlife corridor
3. Old granite quarry – point of interest.
4. Working farm hay fields – field type habitat – old barn – scenic- historic

#6 Bounded by Southeast Main Street, Uxbridge town line, to just above Yew Street



1. Potential vernal pool.
2. Town owned land on Yew Street close to chapter property and abuts unknown owner land.

Motion to adjourn meeting at 3:18 by L. Moczynski, 2nd by S. Perkins. All in favor.